

2021-07

WATER TRANSFER WORKING GROUP PROJECT DESCRIPTION

APPLICATION NO./COURT CLAIM NO.		
Groundwater Right Application No. G4-36070 with mitigation from Trust Water Right No. CS4-01968sb11a(Bb) (Originally diverted from Manastash Creek)		
APPLICANT NAME Jacqueline Johnson	CONTACT Samantha Cox	CONTACT'S TELEPHONE NO 509-962-7680
WATER RIGHT HOLDER'S NAME (if different) Kittitas County (Amerivest)		CONTACT'S EMAIL Samantha.cox@co.kittitas.wa.us

DATE OF APPLICATION September 16, 2019

WATER SOURCE: Well (Well Tag ID AKL-778)	CROP: None
INSTANTANEOUS QUANTITY: 4.48 GPM	ANNUAL QUANTITY: 0.308 ac-ft/yr
PERIOD OF USE: Continuous for 1 domestic connection	
PLACE OF USE: Parcel No. 11305, located within the SW¼ of Section 4, T. 18 N., R. 17 E.W.M.	PURPOSE OF USE: Indoor domestic use.

<p>CONSUMPTIVE USE CALCULATION:</p> <p>Indoor Use: 1 residential connection at 275 gallons per day (gpd) used continuously year round equates to 0.308 ac-ft/yr of water use, or: Consistent with WAC 173-539A-050(3), 30% of domestic in-house use on a septic system is consumptively used, therefore: indoor consumptive use (CU) = 0.092 ac-ft/yr.</p> <p>Outdoor Use: The requestor/applicant proposes no outdoor irrigation.</p> <p>Total Consumptive Use = 0.092 ac-ft/yr</p>
--

NARRATIVE DESCRIPTION OF PROJECT:

The project is located approximately 0.44 miles from Taneum creek in a “Red/Green” area as noted on Ecology’s current Mitigation Suitability Map (see attached map).

The requestor/applicant proposes to offset the 0.092 ac-ft/yr of consumptive use for the project (1 residential connection and ft² of lawn and garden) with 0.092 ac-ft/yr of mitigation from Trust Water Right No. CS4-01968sb11a(Bb). Ecology will assign 0.000 ac-ft/yr to the USBR-Ecology Exchange Contract (Contract No. 09XX101700) to address impacts to the Yakima River.

Review of the local area hydrogeology suggests that the proposed groundwater withdrawals are unlikely to negatively impact Taneum Creek and are not expected to result in severe impacts to existing groundwater uses. Additionally, the groundwater withdrawals are expected to impact the Yakima River but will not cause impairment.

WTWG Project form

Location of G4-36070

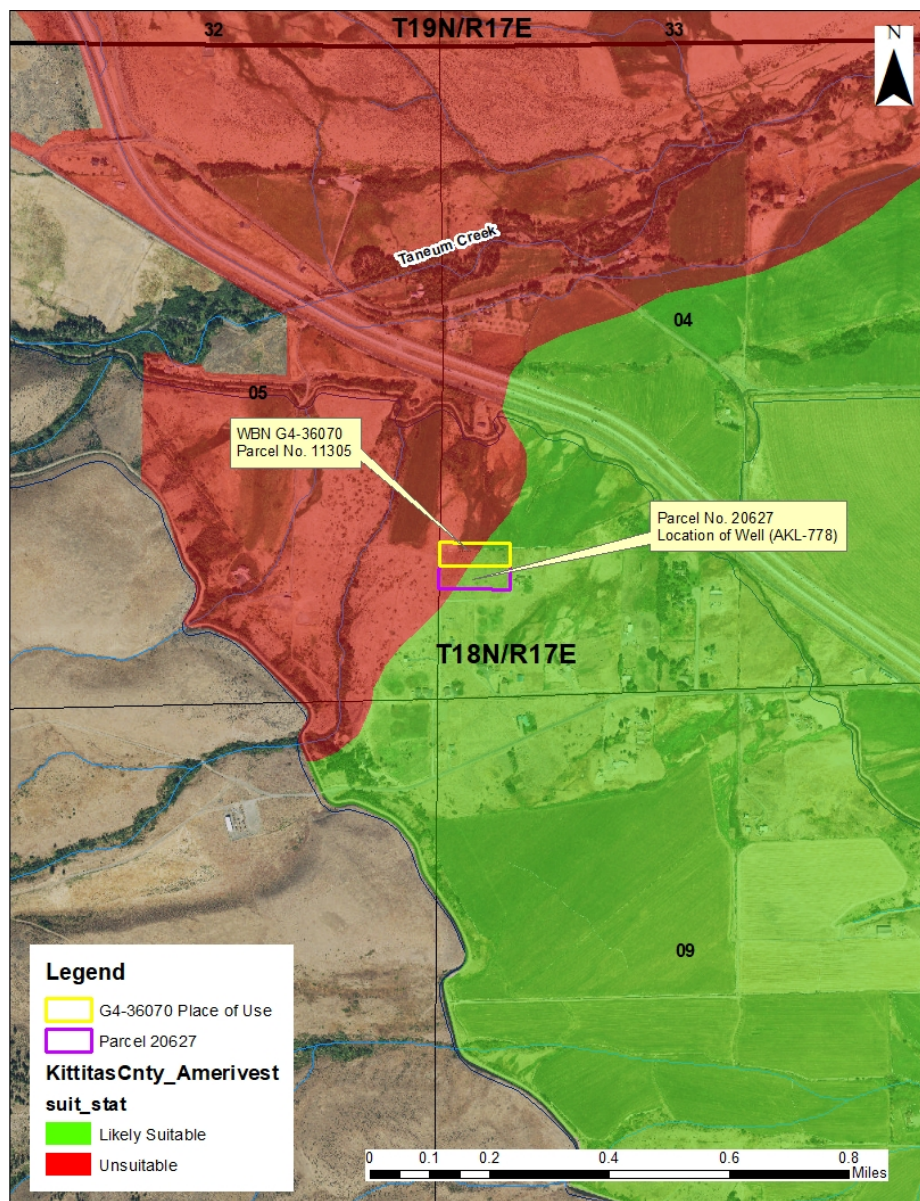

Mitigation Suitability Map Change near Taneum Creek

Ecology has uses maps to advise the public and Kittitas County regarding the suitability of mitigation to offset new permit-exempt groundwater withdrawals in the Yakima River Basin. In approximately 2013, Ecology mapped the drainage area of Taneum Creek as “red” on the advisory mitigation suitability map. A “yellow” need-more-information area was also mapped as a buffer between the “red” and “green” areas. The area was not evaluated further in detail until 2020 while processing two water right applications, which includes the above application G4-36070, located near Joe Watt Canyon south of Taneum Creek.

Ecology staff analyzed the specific application requests and determined the proposed withdrawals were not likely to impact Taneum Creek (full report available upon request.) The technical analysis was then extended to more fully assess groundwater behavior in the area and its relationship with Taneum Creek. It was determined that groundwater withdrawals from within the “yellow” area and a small portion of the “red” area were unlikely to negatively impact Taneum Creek prompting a map update (see Fig 1.)

Figure 1 – Suitability Area Update

