

WATER TRANSFER WORKING GROUP PROJECT DESCRIPTION

APPLICATION NO./COURT CLAIM NO.		
Groundwater Right Application No. G4-36106 with mitigation from Trust Water Right No. CS4-01968sb11a(Bb) (originally diverted from Manastash Creek)		
APPLICANT NAME Matthew Thomas	CONTACT Samantha Cox	CONTACT'S TELEPHONE NO (509) 962-7680
WATER RIGHT HOLDER'S NAME (if different) Kittitas County (Amerivest)		CONTACT'S EMAIL samantha.cox@co.kittitas.wa.us

DATE OF APPLICATION July 21, 2020

WATER SOURCE: Well (Well Tag ID AKL-778)	CROP: Lawn and/or noncommercial garden
INSTANTANEOUS QUANTITY: TBD	ANNUAL QUANTITY: 0.346 ac-ft/yr
PERIOD OF USE: Continuous for 1 domestic connection and season irrigation for lawn and/or garden	
PLACE OF USE: Parcel No. 20627, located within the SW $\frac{1}{4}$ SW $\frac{1}{4}$ of Section 4, T. 18 N., R. 17 E.W.M.	PURPOSE OF USE: Domestic and irrigation of 500 square feet of lawn and/or garden.

<p>CONSUMPTIVE USE CALCULATION:</p> <p>Indoor Use: 1 residential connection at 275 gallons per day (gpd) used continuously year round equates to 0.308 ac-ft/yr of water use, or: Consistent with WAC 173-539A-050(3), 30% of domestic in-house use on a septic system is consumptively used, therefore: indoor consumptive use (CU) = 0.092 ac-ft/yr.</p> <p>Outdoor Use: The requestor/applicant proposes to irrigate 500 ft² of lawn and/or garden. Using a crop irrigation requirement of 31.45 in/yr (or 1.51 ft/yr) for pasture/turf near Ellensburg from the Washington Irrigation Guide and an application efficiency of 80%, the total outdoor irrigation water use is 0.038 ac-ft/yr. Consistent with WAC 173-539A-050(3), 90% of outdoor use is consumptively used, therefore: outdoor consumptive use = 0.034 ac-ft/yr.</p> <p>Total Consumptive Use = 0.126 ac-ft/yr</p>

NARRATIVE DESCRIPTION OF PROJECT:

The project is located approximately 0.49 miles from Taneum Creek in a “red and green” area as noted on Ecology’s current Mitigation Suitability Map (see attached map).

The requestor/applicant proposes to offset the 0.126 ac-ft/yr of consumptive use for the project (1 residential connection and 500 ft² of lawn and garden) with 0.126 ac-ft/yr of mitigation from Trust Water Right No. CS4-01968sb11a(Bb). Ecology will assign 0.000 ac-ft/yr to the USBR-Ecology Exchange Contract (Contract No. 09XX101700) to address impacts to the Yakima River.

Review of the local area hydrogeology suggests that withdrawals are not expected to result in severe impacts to existing groundwater users and will unlikely negatively impact Taneum Creek.

WTWG Project form

Location of G4-36106

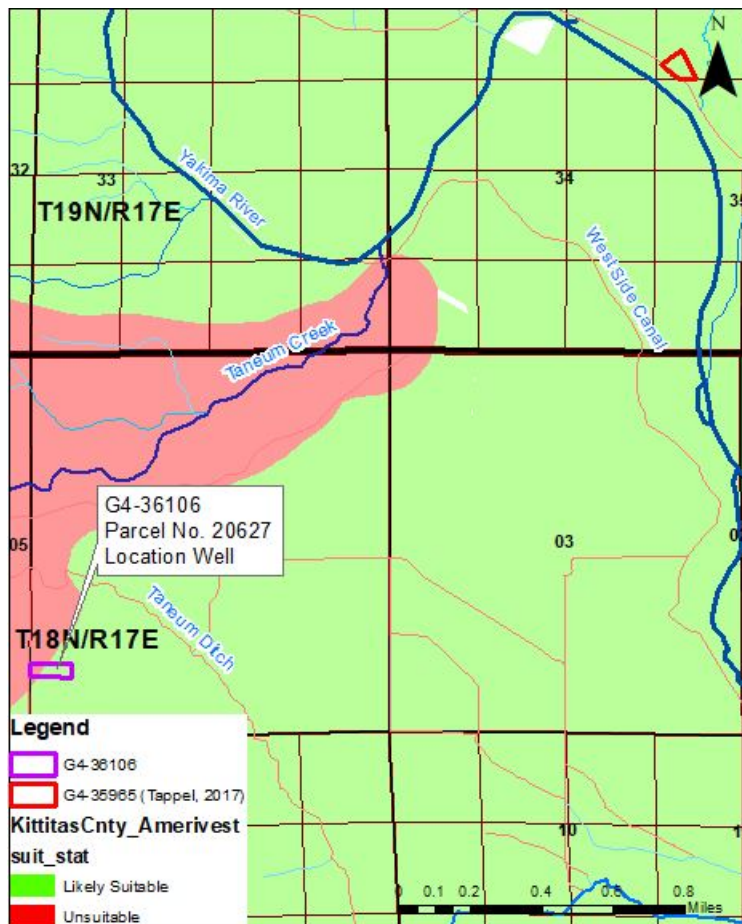

Suitability Map Update Overview

Ecology has uses maps to advise the public and Kittitas County regarding the suitability of mitigation to offset new permit-exempt groundwater withdrawals in the Yakima River Basin. In approximately 2013, Ecology mapped the drainage area of Taneum Creek as “red” on the advisory mitigation suitability map. A “yellow” need-more-information area was also mapped as a buffer between the “red” and “green” areas. The area was not evaluated further in detail until 2020 while processing two water right applications located near Joe Watt Canyon south of Taneum Creek.

Ecology staff analysed the specific application requests and determined the proposed withdrawals were not likely to impact Taneum Creek (full report available upon request.) The technical analysis was then extended to more fully assess groundwater behavior in the area and its relationship with Taneum Creek. It was determined that groundwater withdrawals from within the “yellow” area and a small portion of the “red” area were unlikely to negatively impact Taneum Creek prompting a map update (see Fig 1.)

Figure 1 – Suitability Area Update

